

Features





- High pressure hydraulic quick disconnect fittings for quick assembly and disassembly of hydraulic lines.
- Material = Carbon Steel
- Available in NPT and SAE O-ring Boss threads
- Optional ISO5675 general purpose or ISO 16028 no spill, 200 hour salt tested designs
- NBR seals for use with mineral based oils
- Temperature range -20°C to 100°C



Ordering Details

QD-	O8	M-	C-	ISO56-	1
-----	----	----	----	--------	---

Quick Disconnect Size 1 End type: M=Male, F=Female Material: C = Carbon Steel Option: ISO56= per ISO 5675, general purpose ISO16= per ISO 16028, no spill, salt test* Series

Illustration	Size 1	Size 1 Thread details	End type	Option	Max. Pressure bar	Rated Flow at 2.5bar drop lpm	
 F- Female	O4	SAE -4, O-ring Boss, 7/16-20	M	ISO56	345	11.5	
	O4	SAE -4, O-ring Boss, 7/16-20	F	ISO56	345	11.5	
	N.5	1/2" -14 NPTF	M	ISO56	275	45.5	
	N.5	1/2" -14 NPTF	F	ISO56	275	45.5	
	O8	SAE -8, O-ring Boss, 3/4-16	M	ISO56	275	45.5	
	O8	SAE -8, O-ring Boss, 3/4-16	F	ISO56	275	45.5	
	N.75	3/4"-14 NPT	M	ISO56	210	106	
	N.75	3/4"-14 NPT	F	ISO56	210	106	
 M- Male	O12	SAE -12, O-ring Boss, 1 1/16-12	M	ISO56	210	106	
	O12	SAE -12, O-ring Boss, 1 1/16-12	F	ISO56	210	106	
	N1	1" 11-1/2 NPT	M	ISO56	210	190	
	N1	1" 11-1/2 NPT	F	ISO56	210	190	
	O16	SAE -16, O-ring Boss, 1 5/16-12	M	ISO56	210	190	
	O16	SAE -16, O-ring Boss, 1 5/16-12	F	ISO56	210	190	
	 F- Female	N.5	1/2" -14 NPTF	M	ISO16	276	45.5
		N.5	1/2" -14 NPTF	M	ISO16	276	45.5
O8		SAE -8, O-ring Boss, 3/4-16	M	ISO16	276	45.5	
O8		SAE -8, O-ring Boss, 3/4-16	M	ISO16	276	45.5	
N.75		3/4"-14 NPT	M	ISO16	210	106	
N.75		3/4"-14 NPT	M	ISO16	210	106	
 M- Male		O12	SAE -12, O-ring Boss, 1 1/16-12	M	ISO16	210	106
		O12	SAE -12, O-ring Boss, 1 1/16-12	M	ISO16	210	106

*no spill, 200 hour salt tested.

Example Part Number: QD-O8M-C-ISO56-1

Dimensions

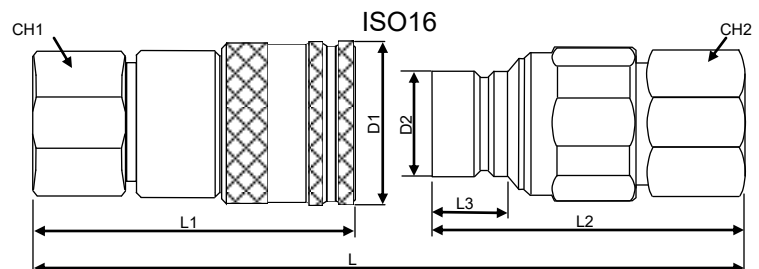
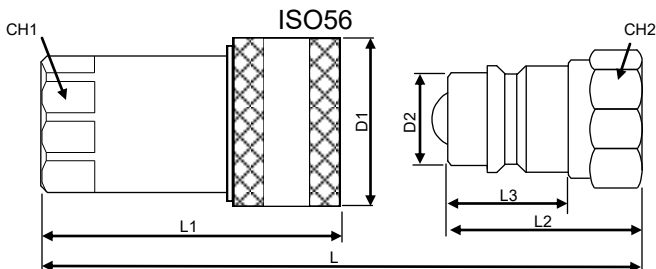

Size	L	L1	L2	L3	D1	D2	CH1	CH2
O4	72	53.5	37.5	18.5	27.5	14.2	19	19
O8/N.5	88	66.5	43.5	27	38.5	20.5	27	27
O12/N.75	108	82	53.5	32	48	28	34	34
O16/N1	127	96.5	63	38	56	31.3	41	41

Size	L	L1	L2	L3	D1	D2	CH1	CH2
O4	96	58	49	11.8	28	16.2	20	20
O8/N.5	129	75	72	17.8	38	24.5	32	32
O12/N.75	138	80	75.5	17.5	42	27	36	36
O16/N1	172	100	94	23.5	48	30	41	41

Dimensions (mm)

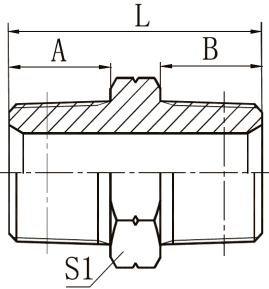

Part Number	A	B	L	S1
F-O8M-O8M-1	19.5	19.5	47	22

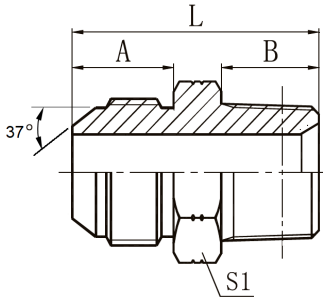

Part Number	A	B	L	S1
F-N.25M-J.3M-1	19.5	19.5	47	22
F-N.5M-J.3M-1	14	19.5	41.5	24
F-N.5M-J.5M-1	16.7	19.5	44	24
F-N.5M-J.6M-1	19.5	19.5	47	24
F-N.75M-J.6M-1	19.5	19.5	49	30
F-N.75M-J.75M-1	23	19.5	53.5	36

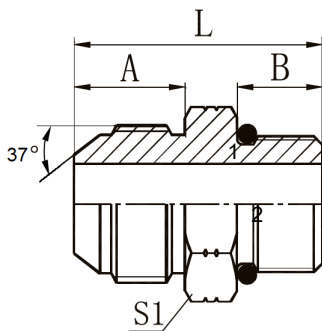

Part Number	A	B	L	S1
F-O4M-J.3M-1	14	9	29	17
F-O8M-J.3M-1	14	11	33	22
F-O8M-J.5M-1	16.7	11	36	22
F-O8M-J.6M-1	19.5	11	39	24
F-O10M-J.3M-1	14	12.7	37	27
F-O10M-J.5M-1	16.7	12.7	40	27
F-O12M-J.6M-1	19.5	15	45.5	32
F-O12M-J.75M-1	22	15	48	32
F-O16M-J.75M-1	22	15	48	38
F-O16M-J.1M-1	23	15	49	38

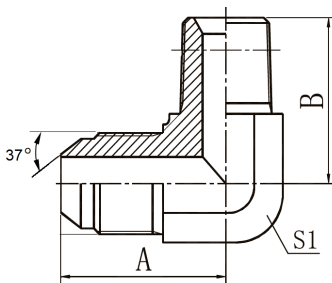

Part Number	A	B	S1
F-N.25M-J.3M-1	26.9	25.5	14
F-N.5M-J.3M-1	32	36.7	22
F-N.5M-J.5M-1	34.8	37.3	22
F-N.75M-J.6M-1	41	44	27
F-N.75M-J.75M-1	44.2	44	27
F-N1M-J.75M-1	49	50	33
F-N1M-J1M-1	49	50	33

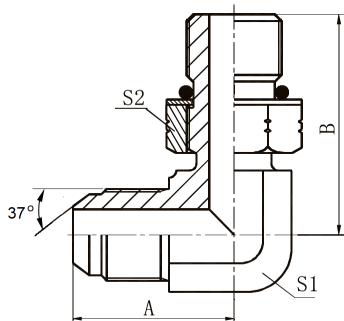

Part Number	A	B	S1	S2
F-O8M-J.3M-1	30	36.8	19	24
F-O8M-J.5M-1	33	36.8	19	24
F-O10M-J.5M-1	34.8	44	22	27
F-O10M-J.6M-1	37.8	44	22	27
F-O12M-J.6M-1	41	51	27	32
F-O12M-J.75M-1	44.2	51	27	32
F-16M-J.75M-1	47.8	54.5	33	41
F-16M-J1M-1	49	55.5	33	41